

# TERMINALE SERRAGGIO CON GRANI - FIL. INTERNO **A4-AISI 316**

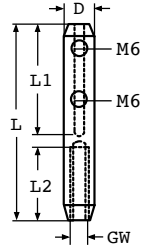

| Ø FUNE | FILETTO | L  | L1 | L2 | D  |
|--------|---------|----|----|----|----|
| 3+4    | M6 dx   | 80 | 45 | 30 | 12 |
| 3+4    | M6 sx   | 80 | 45 | 30 | 12 |
| 5      | M6 dx   | 80 | 45 | 30 | 12 |
| 5      | M6 sx   | 80 | 45 | 30 | 12 |